

Wi-Fi/ GSM
SmartCam Alarm System
User Manual

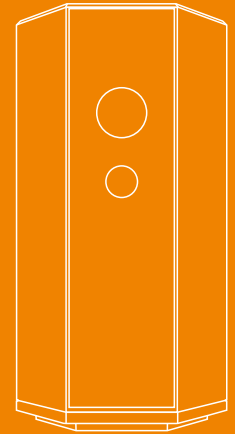

Table of Content

- 02 **Get to Know Your System**
- 05 **Working Status of Control Panel**
- 07 Four Ways to Control System
- 11 Wireless Accessories Enrolling and Clearing
- 13 Zone Setup
- 15 **App Operation**
- 15 How to Download the Mobile Apps
- 16 Creat an Account

- 17 **User Setup**
- 18 Add Devices
- 19 **Quick Settings**
- 20 User Management
- 21 Link Installation

- 25 **App Setting**
- 25 Switch to Alarm Smartcam All-in-one Dashboard
- 26 Video Monitoring Interface
- 31 Alarm System Interface

- 32-39 **System Setup**
- 40 Specifications
- 41 Frequently Asked Questions

SmartCam Alarm System

This is not only a surveillance system, but also a functional alarm security system. You can check your house anywhere, anytime via mobile app. It's designed to provide full protection with powerful 90dB siren and complete range of accessories. You will get alerts in time when the sensor is triggered. It supports Wi-Fi and GSM cellular network (as secondary backup). Dual path communication is the most secure way to have an alarm system communicates. And you will get notified right away when any unordinary happens with push notification, SMS text or voice phone call, and be always connected.

Contents

Please remove all supplied contents from packaging as below. If there's anything missing, please return to your purchasing place.

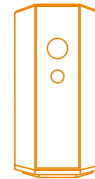

Smartcam Alarm System



Eject Tool



SIM Card Tray



16G TF (Class 10) Memory Card



Micro Cable

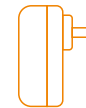

USB Power Adapter



User Manual

★ Features



Totally Wireless,
DIY Installation



Up to 50 Zone Names
Can be Customized



24 Hours Protection



Entry/Exit Delay



Wi-Fi + GSM,
Double Safety



FHSS Frequency-Hopping
Spread Spectrum



Immediate
SMS Alerts



3 Groups of SMS
5 Groups of Phone Call
2 Groups of Central
Monitoring Station



10 Hours
Battery Back-up



Customizable
Keyfob Name



Added on up to
50pcs Sensors



iOS & Android App,
Easy to Setup



Accessories Selection

Smartcam Alarm System can expand 50 pcs of accessories. User can purchase any of them if needed. Some main accessories are recommended as below. For more, please contact vendor.



PIR+Door Sensor



Door+Vibration Sensor



Water Leakage Sensor



Indoor Siren &
Door Bell Chime



RF Signal Repeater

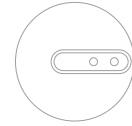

Smoke Detector



Strobe Indoor Siren



Wireless Keypad

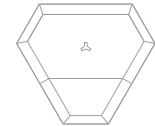

Outdoor Strobe Siren



Working Status of Control Panel

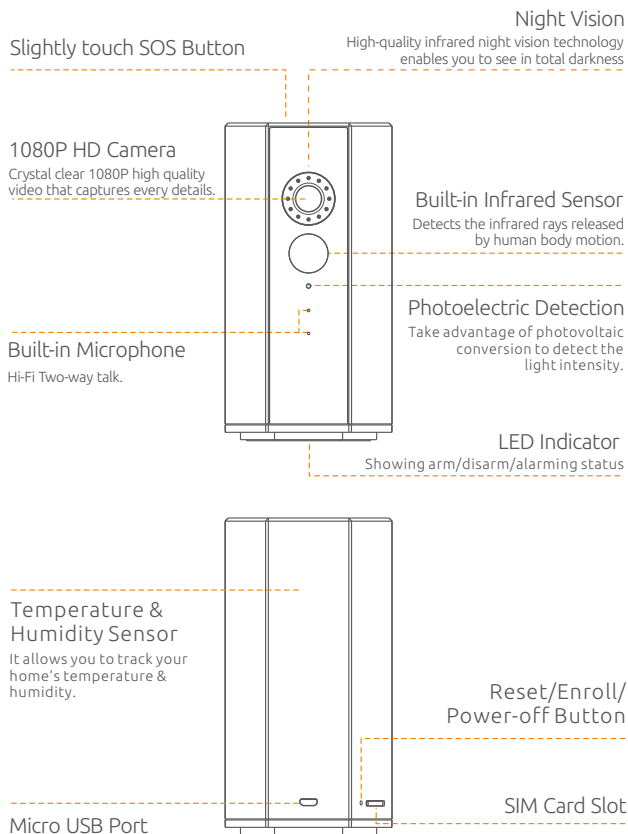

Bottom LED Indication

Enroll Status:



Red LED Normally On:
System enters enrolling status



Red LED Flashes Twice:
Accessory has been enrolled before.



Red LED Flashes Once:
The enrollment is successful.



Red LED Flashes 3 Times:
The enrollment storage is full.

Other Status:



Red LED Flashes Quickly 3 Times:
Connecting Network



Red LED Flashes Quickly
Receiving a SMS



Red LED Flashes Continuously:
System is Alarming.









Red LED Flashes Slowly Once:
Receiving a Signal from Enrolled Accessory.

Status Indication	System Armed in Away Mode	System Armed in Stay Mode	System Disarmed
GSM Signal Normal Wi-Fi Signal Normal	Green LED Normally On	Blue LED Normally On	White LED Normally On
GSM Signal Unnormal Wi-Fi Signal Normal	Green LED Flashes Quickly	Blue LED Flashes Quickly	White LED Flashes Quickly
GSM Signal Normal Wi-Fi Signal Unnormal	Green LED Flashes Slowly	Blue LED Flashes Slowly	White LED Flashes Slowly
GSM Signal Unnormal Wi-Fi Signal Unnormal	Yellow LED Normally On		



Four Ways to Control System

You can control your smartcam security alarm system by arming, disarm ing, stay arming or sending emergency signal via remote control, SMS text command, touch tone phone and mobile apps.

Function	App Operation	Remote Control	Phone Remote Control	SMS Text Operation		
	Please enter keyword "Ontips Pro" to download the apps from the App Store or Google Play. And use the email address to Create an Account.	It's a simple and valuable tool which can be reached easily for arming, disarming or SOS.	When alarming, system will call the preset phone number. User should pick up the phone to press key to monitor the site or press any buttons to remote control your alarm system.	Send this operation code from your cell phone	SMS reply you will receive	Remark
Menu		---	---	?	---	Send a text on "?" to the SIM card number of control panel , the system will reply you a main operation guide menu . Send "password#command code" (original password is 1234) to setup,for example "password#5" to store phone numbers.
Disarm			0	1234#0	System Disarmed	---
Arm			1	1234#1	System Armed in Away Mode	---
Stay Arm			2	1234#2	System Armed in Stay Mode	The Arm/Stay function will arm the system with sensors in normal zone activated immediately, but sensors in home mode zone disabled.
Status Inquiry	---	---	---	1234#3	(Please Text Below Command Code to Inquiry the System Setting) 31: Control Panel Status 32: IMEI Information	---

Function	App Operation	Remote Control	Phone Remote Control	SMS Text Operation		
	Please enter keyword "Ontips Pro" to download the apps from the App Store or Google Play. And use the email address to Create an Account.	It's a simple and valuable tool which can be reached easily for arming, disarming or SOS.	When alarming, system will call the preset phone number. User should pick up the phone to press key to monitor the site or press any buttons to remote control your alarm system.	Send this operation code from your cell phone	SMS reply you will receive	Remark
System Status Inquiry	---	---	---	31	System Status: Away Armed AC Power: On Alarm Type: Audible Local Siren: On SMS Alert for Keyfob Operation: Off	---
IMEI No.	---	---	---	32	IMEI No.: **** * * * * *	IMEI is International Mobile Equipment Identity number, consist of 15 digits "electronic serial number" which is unique to identify valid devices. Every alarm panel will be assembled with an unique IMEI number to make sure it's original from manufacturer.
Alarm Management			---	1234#4	(Please Text Below Command Code to Manage the System) 41: Turn On the Local Siren 42: Turn Off the Local Siren 43: Two-way Talk	---
Turn On the Local Siren			7	41	Local Siren: On	---
Turn Off the Local Siren		---	8	42	Local Siren: Off	As Default
Two-way Talk		---	*	43	---	Send "43" to the SIM card number, the control panel will call back. You can now listen in and have a two-way talk.



Wireless Accessories Enrolling and Clearing

Wireless Accessories Enrolling

1. Use the Eject Tool to press the enroll button slightly.
System enters enrolling status when bottom LED is normally on. (Slightly press it again to exit)
2. Connecting Remote Control to Control Panel:
Press any button on the remote control.
3. Connecting Door Sensor to Control Panel:
Depart the transmitter and magnet
4. Bottom LED flashes once, the enrollment is successful;
Bottom LED flashes twice, the accessory has been enrolled before. Bottom LED flashes 3 times, the storage is full.

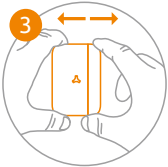

! Note! Wireless siren is not included as wireless accessory. For specific details, please refer to the manual of siren. User can not trigger accessory's tamper switch button to enroll into system.

Add Wireless Accessories by Mobile App.

Switch to accessories interface, you can manage the accessories name and type.

1. Tap on " + " to add more accessories, follow the enrolling instruction.
2. Connecting remote control: Press any button on the remote control.
3. Connecting Door Sensor to Control Panel: Depart the transmitter and magnet.
4. Connecting more accessories.

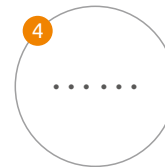
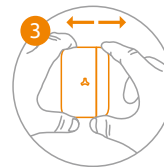

Delete Enrolled Wireless Accessories

Press and hold the built-in multi-function up to 5 secs until one beep is heard, all enrolled wireless accessories will be deleted.



Zone Setup

After accessories added, you can choose zone type and change zone name for quick positioning after sensors are triggered.



Normal Zone

Sensors set in normal zone(immediate alarm zone), once triggered in arming state, the system will receive the signal and activate the alarm immediately.



Single Delay Zone

If exit/entry delay time is set, accessories in single delay zone will be delayed for arming/disarming. But accessories in normal zone, home mode zone, and 24H zone will not be delayed.



Stay Mode Zone

Stay mode is known as "part arm". When system is stay armed, the accessories in home mode are disarmed. This allow users to move freely at home. But the accessories in normal zones will activate an immediate alarm when triggered.



24 Hour Zone

No matter what state the alarm system is in, the accessories in 24 Hour zone are triggered, the control panel will get the signal and alarm immediately.



Built-in Multi-function Button Operation (System should be powered on)

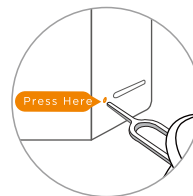

1. Restore system to factory default

Slightly press the button **5** times, system restore to factory default until one beep is heard. All preset numbers will be deleted at once, IPC is restored to default AP mode and the system is restored to default setting successfully.

Note! Restoring operation will not delete the enrolled accessories.

2. Enter connecting network status

Slightly press the button **3** times, the bottom red LED flashes 3 times to enter connecting network status.

3. Turn off system

Slightly press the button **10** times to turn off system.



Download Apps

Please enter keyword "Ontips Pro" on your smart phone to download the apps from the App store or Google Play.

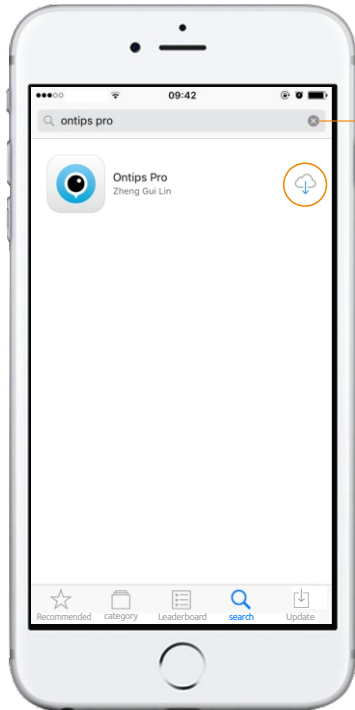

Search the keyword "Ontips Pro"



Create an Account

Please create an account when you use the mobile apps first time, tap on "Create an Account" and follow these steps to create an account for your devices. Tap on "Done" to start login and setup after creating your account.

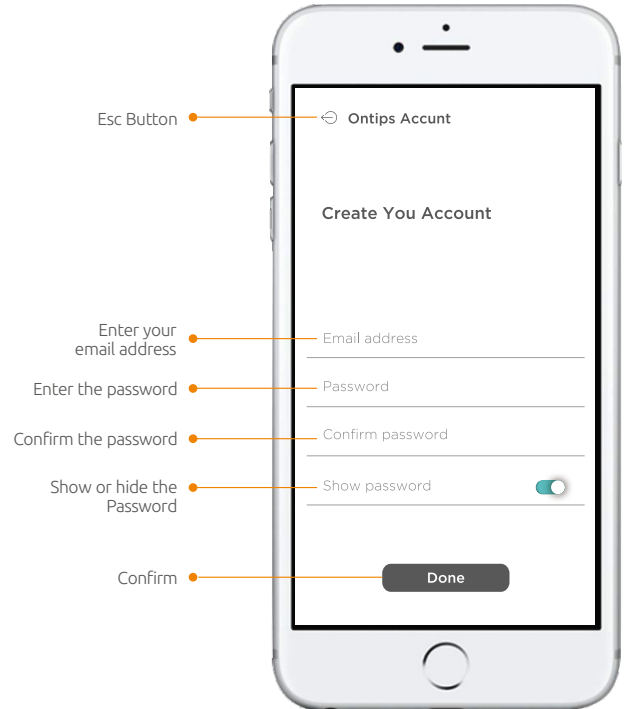

Esc Button

Enter your email address

Enter the password

Confirm the password

Show or hide the Password

Confirm



User Setting

Tap on "☰" to start setup.

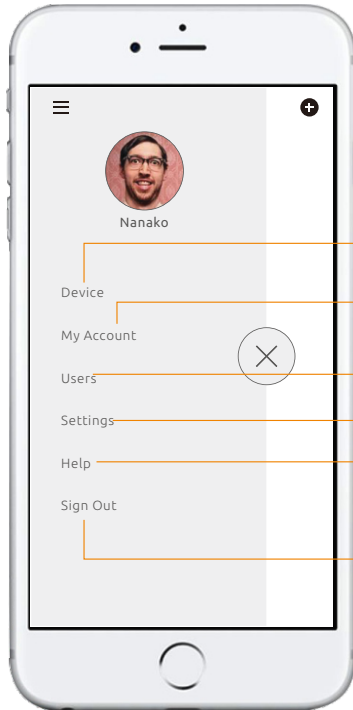

- Check the current devices and add multiple devices
- User profile(user name/ image/email etc)
- Share your device with others
- Time schedule/Emergency call/Notification sound
- Help center/ Contact support
- Sign out



Add Device

Tap on "⊕" to add new devices, choose the device you want to add and start setup.

Add device

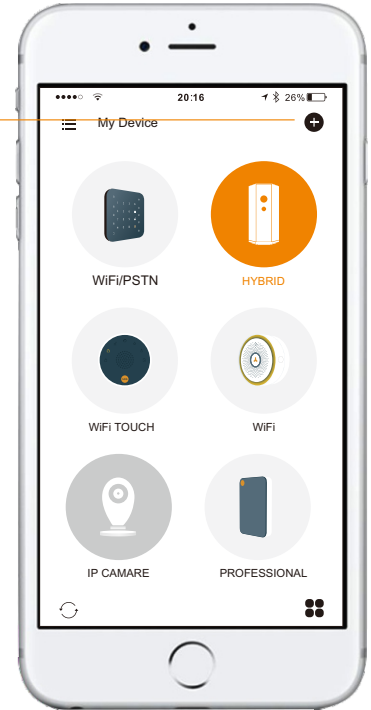

Quick Setting

Tap on "Settings" to set your time schedule, emergency number and notification sound.

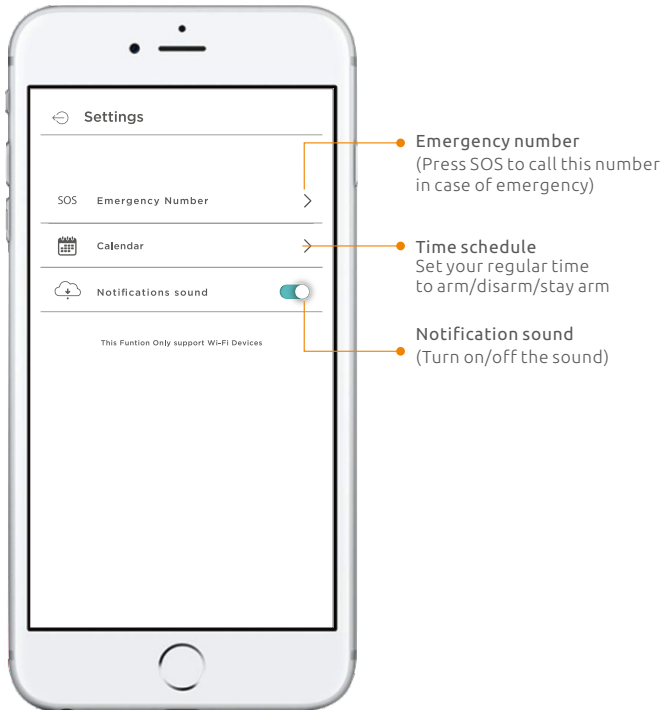

Users Management

Tap on "Users" - "+", add the new users according to different access authority.

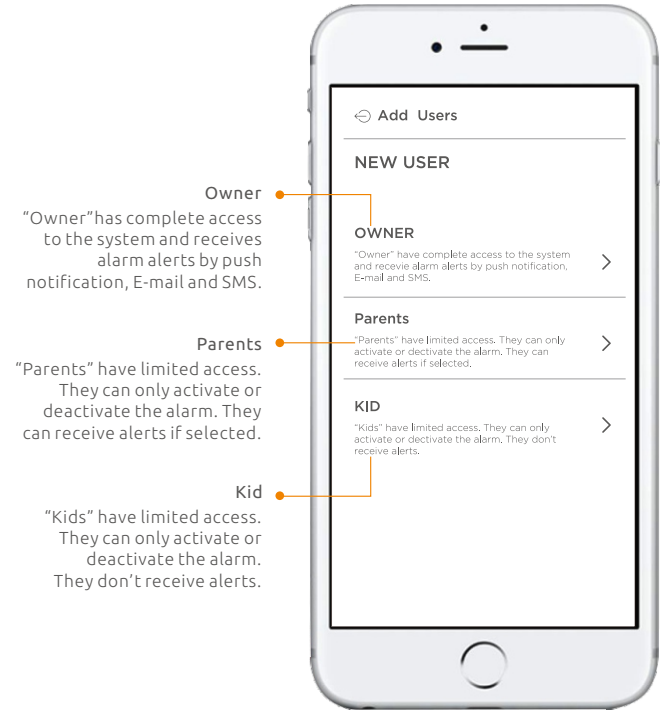



Link Installation

1. Insert Sim Card if you need gsm network as the backup communication. (For WiFi/GSM version only.) Only WiFi version, please skip this step.

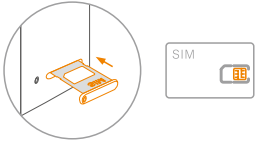

Note: Only use supplied adapter and cable, other brand adapter and cables are not applicable.

2. Connect the cable to the micro USB port.

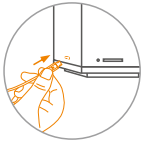

3. Plug it into a power outlet.

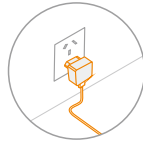

4. Add device

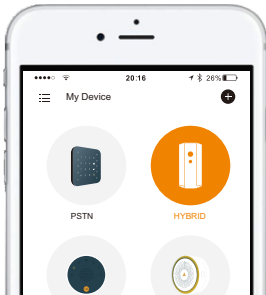

5. Use the Eject Tool to press the multi-functional button for 3 times, the red LED flashes for three times, it shows system has entered into connection status.



6. Enter the WIFI account and password

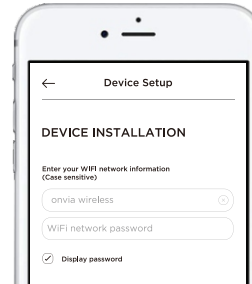

7. Leave for mobile phone setting.



Setting

8. Select Wi-Fi which names Smartcam_xxx.



Note! Please make sure the mobile and device are in the same network.

9. Back to Ontips pro app.



Ontips pro

10. Device is connecting, please wait.

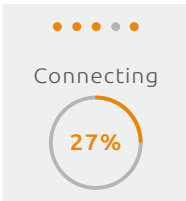

11. Please enter your account name and sim card number.

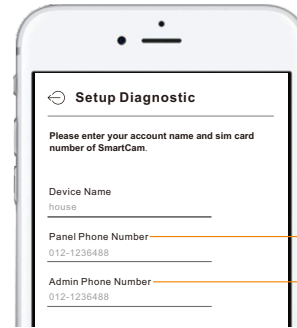

Sim Card Number for Device

Phone number used to control over the device

12. If you want to name your device, enter device menu, and tap on "i" to proceed.

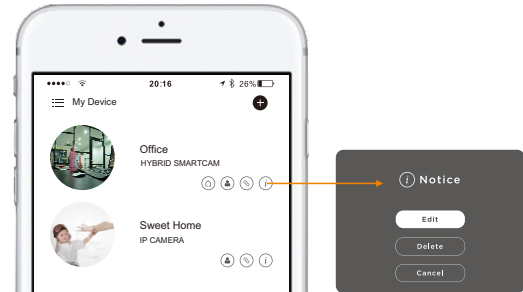



Switch to Alarm Smartcam All-in-one Dashboard

The Dashboard displays information about the present state of your home: the live streaming video, the status of your home alarm and accessories. This mode is recommended for using Wi-Fi network.

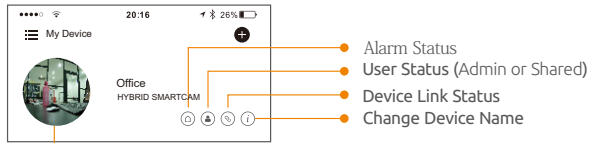

Tap on "Device Picture" to enter Alarm Smartcam All-in-one Dashboard

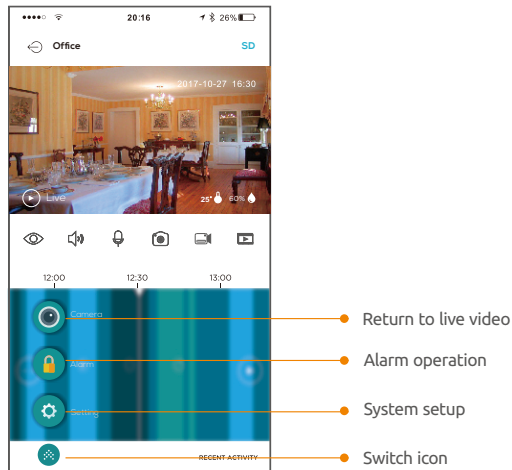

Video Monitoring Interface

Perfect user experience, quick check at the temperature, humidity, video, sound, voice...

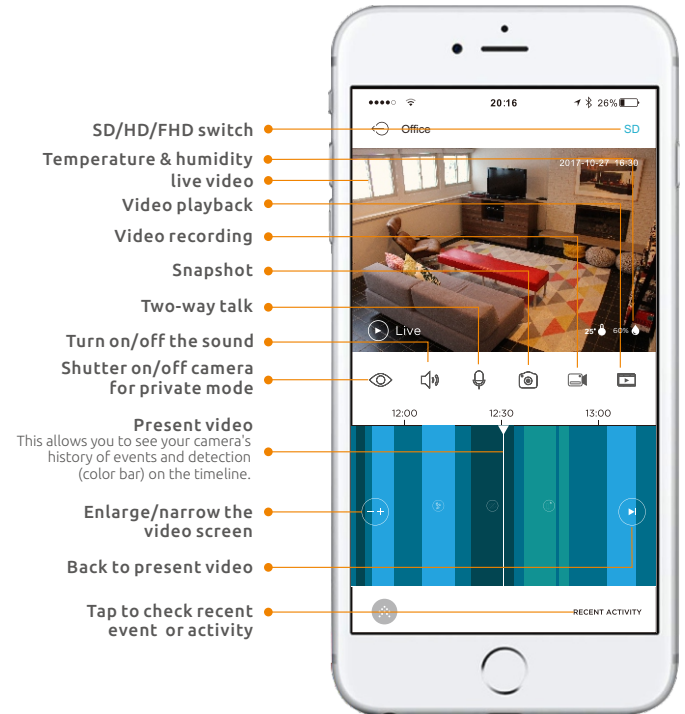

▶ Video Playback

On the All-in-One Interface, tap on "📺" to enter "Video Playback" menu, you can review past activity in the time line and video clip. tap on "⏪" to exit.

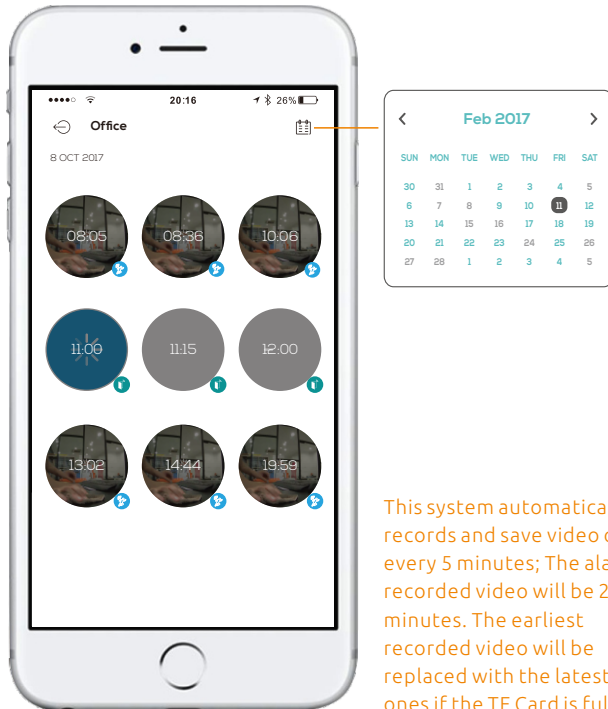

🔥 Temperature & Humidity Monitoring

On the All-in-One Interface, tap on "55° 60%" to check real-time temperature and humidity for previous 24 hours. It makes sure that you always come back to a comfortable home.

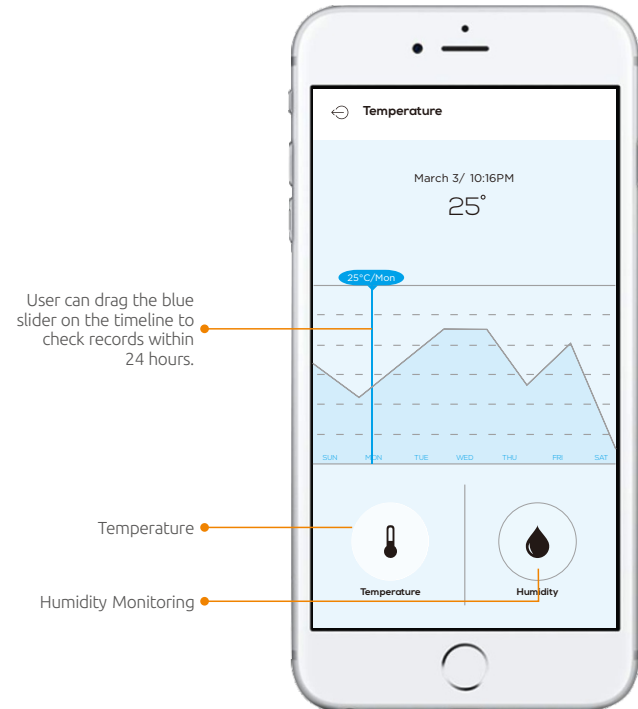



Quick Alarm Operation

Tap on "  " enters quick alarm operation.

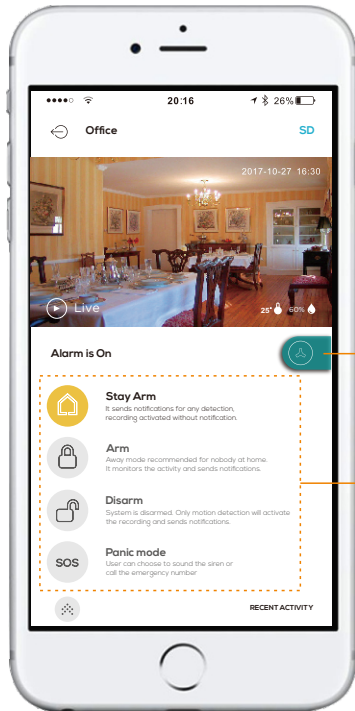

Accessories management

Alarm operation
The icon for current status shows in orange color.



Accessories Management

Tap on "  " icon enters into accessories menu, users can enable/disable, add/delete different accessories. It's highly recommended to set the zone name to recognize the location when it's alarming. For zone types, please refer to P13.

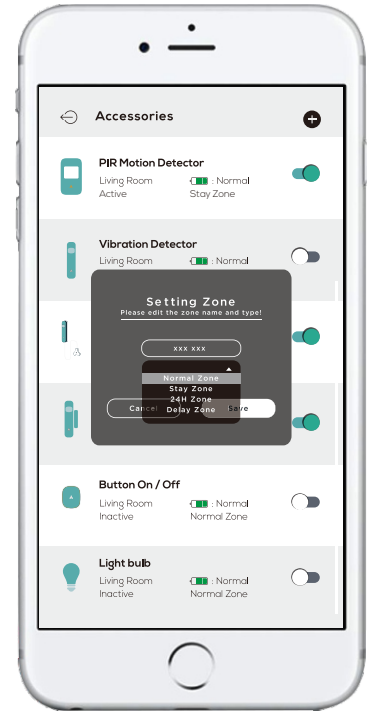



Alarm System Interface

GSM Alarm System Interface

"Device"--->Tap on "device name"--->Enter alarm system operation interface. This mode is recommended for using GSM network to save data.

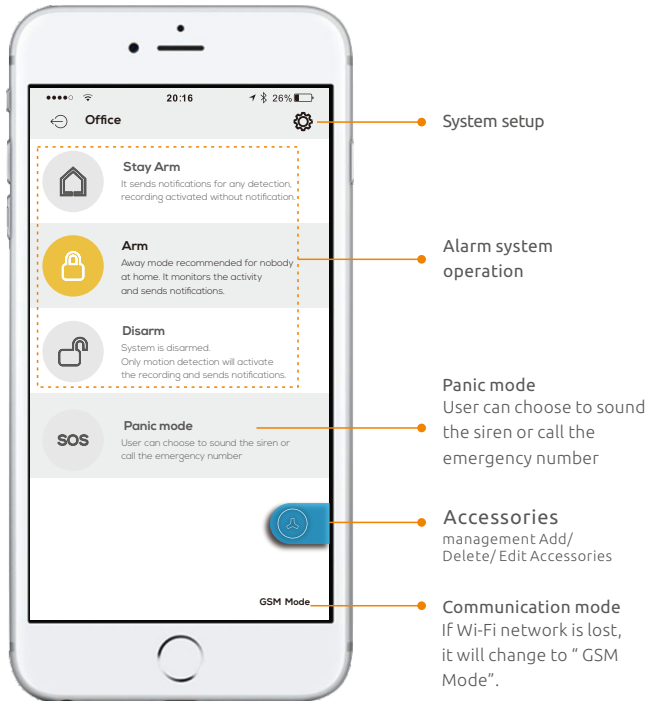

System Setup

Device--->Device Name--->Enter Alarm System Interface---> " ⚙️ ", Enter System Setting

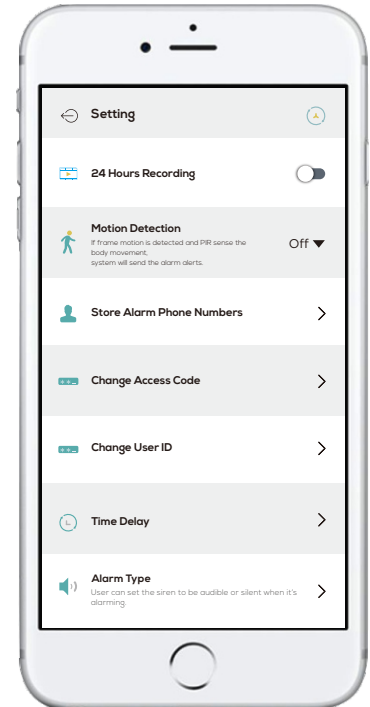



24 Hours Recording

24 Hours continuous recording will simply record whether there is movement or not. Alarm activated recording will record only when alarm is triggered and stop once it's disarmed. This saves you hours of wasted space.



Motion Detection

The motion detection is detecting a scene changes in the field of view of a camera. After motion detection is enabled, when it detects the frame changes, the control panel will push motion detection notification. The users are able to turn on/off it, and the sensitivity can be adjusted for four levels, "Low", "Medium", "High", "Highest". It's highly recommended to set the sensitivity to be " Highest" level.



Store Alarm Phone Numbers

Add phone numbers that you want to control over. Phone numbers includes 3 SMS numbers (where you want security message and alerts sent) , 5 Tel numbers (to receive alarm calls) and and 2 CMS numbers. It's recommended to set the numbers according to the priority.



Change Access Code

Setup---->Change Access Code---->Reset Password, user can change the password, the default password is 1234. The password should be 4 digits between 0 and 9. The password is used for operating by SMS when WiFi network is off.



Central Monitoring Station Setup

1. Change User ID

(Programm User ID for Central Monitoring Station)

The user ID is the Central Station Account number, which should be 4 digits between 0 and 9.



2. Report Upload

Report upload function is disabled as default. If the user needs to connect the central monitoring station, report upload function should be enabled. If enabled, notifies the central station by sending alarm report if alarm event occurs from the security system..



3. Store CMS Phone Numbers

User can set 2 CMS Phone Numbers on menu of "Store Phone Numbers"

Contact ID Event Code and Content

Event Code	Event Content
3401	Arm
1401	Disarm
1132	PIR Motion Sensor Alarm
1131	Window/Door Sensor Alarm
1100	Emergency call
3456	Stay Arm
1137	Control Panel Tamper Alarm
1144	Detector Tamper Alarm
1140	Normal Alarm
1133	24H Alarm
1384	Detector Low Battery
1302	Control Panel Low Battery
1301	Control Panel AC Power Lost

Exit/ Entry Delay

Set exit/entry delay time for accessories in single delay zone. It allows users to leave or enter home within the programmed time without activating an instant alarm. Once entry/exit delay time is set, when system is armed, in case of delay time less than 10 seconds, control panel will beep once every second. While delay time more than 10 seconds, control panel will beep once every 2 seconds, the sound will increase in tempo for the last 10 seconds for the "hurry up" notification. Once an entry is detected, it will allow the user to enter and disarm the system within the programmed entry time



Alarm Type

User can set the siren to be audible or silent when it's alarming.



Keyfob Alert

When system alarms, user can choose to get push notification and SMS alerts or not if someone operate it by keyfob.





Change language

Change system language as you want.



Supervision for Door Sensor

User can turn on or off the supervision for door sensor, once it's enabled, user cannot arm the system when door or window is open. You will always be informed with control panel beeping and text message to your phone (**zone door is open, please close it and then arm the system again) if your garage door is left open. User can force to arm it by pressing "arm" button again within 5 seconds.



Trigger Detection

Someone who move, shake or attempt to take the control panel, it will activate an instant alarm and send push notification directly to mobile apps or phone.



GSM Signal Monitor

When the GSM signal is lost, the system will raise an alarm. When GSM signal is lower than 20, the system will send SMS notification.



Turn on/off Local Siren

When you turn on the local siren, the control panel will alarming immediately.



Change Keyfob Name

Change your keyfob (remote control) name, then you will easily to know who operate your system. Up to 10pcs remote control can be added.

Note! Keyfob alert function should be enabled.



Sim Card Balance

Check your balance by sending a text of balance checking code that says "***" to carrier service number.



Temperature Alarm

It tracks your home's real-time temperature and humidity. Notifications will be sent if temperature exceeds the programmed value.



Change Wi-Fi Network

When if the Wi-Fi network is not good, user can select a stronger Wi-Fi and start to connect your device to the new network.



Storage Format

Formatting your storage card permanently erases all data from your storage card, including personal information.



Firmware Upgrade

If there's a new firmware, the icon will be in red to remind the user to update to the latest firmware. Otherwise it's in white color.



Restarting the Device

Once the system is restored, the new setup will be required.



Specifications

Product Name :	WiFi/GSM SmartCam Alarm System
Control Panel's Power Supply :	Input: 5V/2A
Micro SIM:	2G: GSM 850/900/1800/1900; 3G: WCDMA 850/900/1900/2100
Built-in Battery:	2200mAh/3.7V lithium battery
Standby Current :	≥60 A
Max Alarm Current :	≥1.5A
Internal siren :	90dB
Allowed Amount of Expandable Wireless Accessories :	10pcs remote controls 50pcs wireless accessories
Radio Frequency:	315/433MHz FHSS Hopping Frequency

Camera

Image Sensor:	ON Semiconductor (Aptina) 1/2.7 CMOS Sensor
Min.illuminatin:	0.01lux(IR ON)
Max. Image Resolution:	2 Megapixels (1920*1080P)
Frame Rate:	60fps
Lens:	2.8mm F2.0
IR-LED:	12
IR Distance:	20M
Shutter Time:	1/5-1/15,000 /S
Bit rate:	32-16384kbps
Storage:	16GB TF card supplied, expandable up to 256GB
View Angle:	150 degree view
Video Compression:	H.264
Wireless standards:	IEEE802.11b/g/n
Frequency Range:	2.4GHz~2.4835 GHz
Housing Material :	Aluminium alloy + ABS
Operation Condition:	Temperature: -20°C~55°C Humidity: ≤ 80%(non-condensing)
Size (L x W x H) :	80 x69.3x151mm



Frequently Asked Questions

1. Is it possible to expand more accessories for this security system?

Yes, 50pcs sensors and 10 remote controls can be expanded according to users' need. Full range of accessories will be offered including PIR motion sensors, door sensors, vibration sensors, flood sensors, keypads, sirens and premiere protection beams & fences, environmental sensors like smoke detectors, please refer to details of Accessories.

2. What happens in case of alarm?

Wi-Fi alarm sends you the push notification directly to your mobile apps. If there's GSM cellular for backup, when the WIFI network is offline, it will also send you the SMS and voice call. You can response immediately via the apps, SMS, or key operation of the phone.

3. What internet connection do I need for Wifi system?

All contemporary Wi-Fi standards on 2.4 GHz are supported. The speed of the Internet can have effect on the performance of the system. It is recommended to use a fast and well-functioning Internet connection for optimum performance.

4. Do I have to pay for the app?

All available Ontips Pro apps are free to download (App Store or Google Play). The complete functionality is free.

5. How to download the apps for the security system?

Go to App Store or Google Play to download the application by entering the keyword of "Ontips Pro".

6. Are Ontips Pro mobile apps with all mobile phones?

On all smartphones with a recent version of an iOS or Android operating system, apps are available for download and use. For this functionality, depending on the system, a mobile connection or mobile Internet / Wi-Fi connection is necessary.

7. What's the maximum range between the control panel and accessories?

It's 80 meters in open area. The walls might shorten the distance, it's recommended to install the accessories at the right place, and move the panel to adjust a better signal receiving. If the house is too large, it's better to add a signal repeater to boost the coverage.

8. Will my alarm system work in the event of a power failure?

Yes, They system has rechargeable back-up batteries which can support it working for 10 hours. When the power is recovered, the battery will be recharged. Adapter wire cannot be cut to make sure enough power to the panel.

9. The Sim Card was installed in the control panel, but it cannot connect to the GSM cellular network.

- A. The Alarm System support only GSM Sim Card, Sim Card for CDMA network will not work.
- B. Make sure the system is off when you insert sim card .
- C. Watch the bottom LED light, If the LED flashes quickly, the GSM signal is unnormal , please move the control panel near the outside wall or window to improve the signal reception.
- D. SIM card must be activated, and make sure there's enough credit in the sim card.